

MOISTURE SEPERATOR WITH DRAIN MODULE

Description:

IndoAnushka make Moisture separator with drain module is a value added solution for removal of moisture from the steam headers.

Moisture separator with drain module consists of M.S. fabricated moisture separator with completely assembled drain assembly consisting of ball float steam trap, IndoAnushka make MAINTENO strainer with inbuilt blowdown valve and IndoAnushka make MULTIVIEW double window sight glass with deflector and 1 no. Isolating valve completely assembled with interconnecting piping and 1 no. Outlet nozzle as provision for bypass.

Available Sizes:

15NB ONWARDS upto 300NB.

Pipe Connections:

ANSI 150, 300 & 600.
BS-10 Table-H, J & K

Limiting Conditions:

For Moisture Separator –
Max. working pressure and temperature
as per flange ratings.

For Drain module – Max working pressure-13bars, Max working temp – 180 °C.

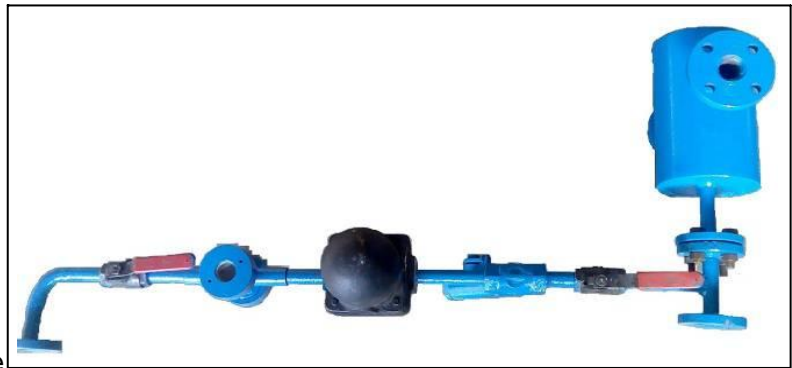

Materials : Body & Baffles – M.S. Fabricated
Strainer – CI with ss internals
Valves – CI

Trap – C.I with ss internals
Multiview- M.S Fabricated
Pipes and flanges – Carbon Steel.

Dimensional Details :

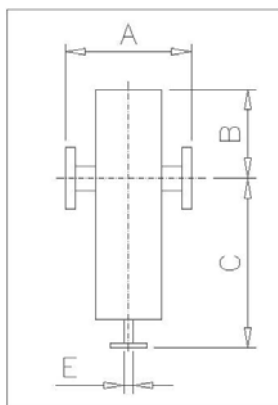

SIZE	A	B	C	E
15 NB	190	100	200	15 NB
25 NB	265	150	295	15 NB
40 NB	265	150	280	15 NB
50 NB	315	220	355	15 NB
80 NB	315	240	480	15 NB
100 NB	370	280	515	15 NB
150 NB	475	395	775	15 NB
200 NB	560	520	840	15 NB
250 NB	560	610	910	15 NB
300 NB	610	660	960	15 NB